

Electret Condenser Microphones

Pad

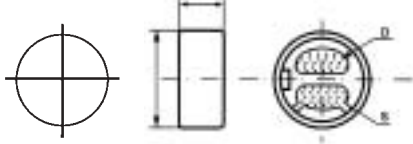

Pin

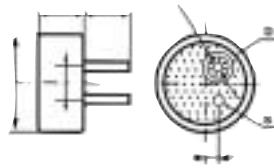

Solderless Type

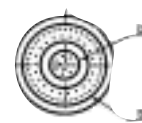

Omnidirectional

RL = 2.2K hms

Part Number	Fig	Sensitivity (OdB=V/ubar, 1KHz ± 3dB)	Frequency Range (Hz)	Operating Voltage		Current Consumption Max.	Sensitivity Reduction	S/N Ratio	Physical Size (mm)	Pin Specifications Len./Center/Pitch (mm)
				Std.	Max.					
MEO-96PD-01-603	Pad	-60	20 ~ 16,000	1.5V	10V	0.3mA	within -3dB @ 1V	>40dB	9.7 x 6.7	N/A
MEO-96PD-03-643 (603,563)	Pad	-64,-60,-56	20 ~ 16,000	3V	10V	0.8mA	within -3dB @ 3V	>40dB	9.7 x 6.7	N/A
MEO-96PD-04-663 (623,583)	Pad	-66,-62,-58	20 ~ 16,000	4.5V	10V	0.8mA	within -3dB @ 3V	>40dB	9.7 x 6.7	N/A
MEO-96PN-01-603	Pin	-60	20 ~ 16,000	1.5V	10V	0.3mA	within -3dB @ 1V	>40dB	9.7 x 6.7	7.0 2.0 2.5
MEO-96PN-03-643 (603,563)	Pin	-64,-60,-56	20 ~ 16,000	3V	10V	0.8mA	within -3dB @ 3V	>40dB	9.7 x 6.7	7.0 2.0 2.5
MEO-96PN-04-663 (623,583)	Pin	-66,-62,-58	20 ~ 16,000	4.5V	10V	0.8mA	within -3dB @ 3V	>40dB	9.7 x 6.7	7.0 2.0 2.5
MEO-94PD-01-643 (623,603)	Pad	-64,-62,-60	20 ~ 16,000	1.5V	10V	0.3mA	within -3dB @ 1.1V	>40dB	9.7 x 4.5	N/A
MEO-94PN-01-643 (623,603)	Pin	-64,-62,-60	20 ~ 16,000	1.5V	10V	0.3mA	within -3dB @ 1.1V	>40dB	9.7 x 4.5	4.5 2.0 2.5
MEO-65PD-02-663 (643,623)	Pad	-66,-64,-62	20 ~ 16,000	2.0V	10V	0.5mA	within -3dB @ 1.5V	>38dB	6.0 x 5.2	N/A
MEO-65PN-02-663 (643,623)	Pin	-66,-64,-62	20 ~ 16,000	2.0V	10V	0.5mA	within -3dB @ 1.5V	>38dB	6.0 x 5.2	7.0 0.8 2.0
MEO-63PD-02-663 (643)	Pad	-66,-64	20 ~ 16,000	2.0V	10V	0.5mA	within -3dB @ 1.5V	>38dB	6.0 x 3.0	N/A
MEO-63PN-02-663 (643)	Pin	-66,-64	20 ~ 16,000	2.0V	10V	0.5mA	within -3dB @ 1.5V	>38dB	6.0 x 3.0	2.8 0.8 2.0
MEO-627PD-02-643 (623,603,583)**	Pad	-64,-62,-60,-58	20 ~ 16,000	2.0V	10V	0.5mA	within -3dB @ 1.5V	>36dB	6.0 x 2.7	N/A
MEO-627PN-02-643 (623,603,583)**	Pin	-64,-62,-60,-58	20 ~ 16,000	2.0V	10V	0.5mA	within -3dB @ 1.5V	>36dB	6.0 x 2.7	2.8 0.8 2.0
MEO-627SM-02-643 (623,603,583)**	Sm	-64,-62,-60,-58	20 ~ 16,000	2.0V	10V	0.5mA	within -3dB @ 1.5V	>36dB	6.0 x 2.7	N/A
MEO-62PD-02-643 (623,603)**	Pad	-64,-62,-60	20 ~ 16,000	2.0V	10V	0.5mA	within -3dB @ 1.5V	>36dB	6.0 x 2.2	N/A
MEO-62PN-02-643 (623,603)**	Pin	-64,-62,-60	20 ~ 16,000	2.0V	10V	0.5mA	within -3dB @ 1.5V	>36dB	6.0 x 2.2	2.8 0.8 2.0
MEO-62SM-02-643 (623,603)**	Sm	-64,-62,-60	20 ~ 16,000	2.0V	10V	0.5mA	within -3dB @ 1.5V	>36dB	6.0 x 2.2	N/A
MEO-618PD-02-643 (623,603)**	Pad	-64,-62,-60	20 ~ 16,000	2.0V	10V	0.5mA	within -3dB @ 1.5V	>36dB	6.0 x 1.8	N/A
MEO-618PN-02-643 (623,603)**	Pin	-64,-62,-60	20 ~ 16,000	2.0V	10V	0.5mA	within -3dB @ 1.5V	>36dB	6.0 x 1.8	2.8 0.8 2.0
MEO-618SM-02-643 (623,603)**	Sm	-64,-62,-60	20 ~ 16,000	2.0V	10V	0.5mA	within -3dB @ 1.5V	>36dB	6.0 x 1.8	N/A
MEO-615PD-02-643 (623)**	Pad	-64,-62	20 ~ 16,000	2.0V	10V	0.5mA	within -3dB @ 1.5V	>36dB	6.0 x 1.5	N/A
MEO-615PN-02-643 (623)**	Pin	-64,-62	20 ~ 16,000	2.0V	10V	0.5mA	within -3dB @ 1.5V	>36dB	6.0 x 1.5	2.8 0.8 2.0
MEO-615SM-02-643 (623)**	Sm	-64,-62	20 ~ 16,000	2.0V	10V	0.5mA	within -3dB @ 1.5V	>36dB	6.0 x 1.5	N/A
MEO-427PD-02-643 (623)**	Pad	-64,-62	20 ~ 16,000	2.0V	10V	0.5mA	within -3dB @ 1.5V	>36dB	4.5 x 2.7	N/A
MEO-427PN-02-643 (623)**	Pin	-64,-62	20 ~ 16,000	2.0V	10V	0.5mA	within -3dB @ 1.5V	>36dB	4.5 x 2.7	2.8 0 1.6
MEO-422PD-02-643 (623)**	Pad	-64,-62	20 ~ 16,000	2.0V	10V	0.5mA	within -3dB @ 1.5V	>36dB	4.5 x 2.2	N/A
MEO-422PN-02-643 (623)**	Pin	-64,-62	20 ~ 16,000	2.0V	10V	0.5mA	within -3dB @ 1.5V	>36dB	4.5 x 2.2	2.8 0 1.6
MEO-418PD-02-643 (623)**	Pad	-64,-62	20 ~ 16,000	2.0V	10V	0.5mA	within -3dB @ 1.5V	>36dB	4.5 x 1.8	N/A
MEO-418PN-02-643 (623)**	Pin	-64,-62	20 ~ 16,000	2.0V	10V	0.5mA	within -3dB @ 1.5V	>36dB	4.5 x 1.8	2.8 0 1.6

Unidirectional

Sensitivity 1KHz±4dB RL = 680 ohms*

MEU-910PD-01-674	Pad	-67	100 ~ 12,000	1.5V	10V	0.5mA	within -3dB @ 1V	>38dB	9.7 x 8.5	N/A
MEU-910PN-01-674	Pin	-67	100 ~ 12,000	1.5V	10V	0.5mA	within -3dB @ 1V	>38dB	9.7 x 8.5	7.0 2.0 2.5
MEU-95PD-01-674**	Pad	-67	100 ~ 12,000	1.5V	10V	0.5mA	within -3dB @ 1V	>38dB	9.7 x 5.2	N/A
MEU-85PD-01-674**	Pad	-67	100 ~ 12,000	1.5V	10V	0.5mA	within -3dB @ 1V	>38dB	8.0 x 5.0	N/A
* MEU-65PD-02-704**	Pad	-70	100 ~ 12,000	2.0V	10V	0.5mA	within -3dB @ 1.5V	>35dB	6.0 x 5.2	N/A
* MEU-636PD-02-704**	Pad	-70	100 ~ 12,000	2.0V	10V	0.5mA	within -3dB @ 1.5V	>35dB	6.0 x 3.6	N/A
* MEU-627PD-02-704**	Pad	-70	100 ~ 12,000	2.0V	10V	0.5mA	within -3dB @ 1V	>35dB	6.0 x 2.7	N/A

Noise Cancelling

Sensitivity 1KHz±4dB RL = 680 ohms*

MEC-95PD-01-744**	Pad	-74	100 ~ 10,000	1.5V	10V	0.5mA	within -3dB @ 1V	>38dB	9.7 x 5.2	N/A
MEC-85PD-01-744**	Pad	-74	100 ~ 10,000	1.5V	10V	0.5mA	within -3dB @ 1V	>38dB	8.0 x 5.0	N/A
* MEC-65PD-01-744**	Pad	-74	100 ~ 10,000	1.5V	10V	0.5mA	within -3dB @ 1V	>38dB	6.0 x 5.2	N/A
* MEC-636PD-02-714**	Pad	-71	100 ~ 10,000	2.0V	10V	0.5mA	within -3dB @ 1.5V	>30dB	6.0 x 3.6	N/A
* MEC-627PD-02-714**	Pad	-71	100 ~ 10,000	2.0V	10V	0.5mA	within -3dB @ 1.5V	>30dB	6.0 x 2.7	N/A
* MEC-622PD-02-714**	Pad	-71	100 ~ 10,000	2.0V	10V	0.5mA	within -3dB @ 1.5V	>30dB	6.0 x 2.2	N/A
* MEC-618PD-02-714**	Pad	-71	100 ~ 10,000	2.0V	10V	0.5mA	within -3dB @ 1.5V	>30dB	6.0 x 1.8	N/A
* MEC-427PD-02-744**	Pad	-74	100 ~ 10,000	2.0V	10V	0.5mA	within -3dB @ 1.5V	>30dB	4.5 x 2.7	N/A
* MEC-422PD-02-744**	Pad	-74	100 ~ 10,000	2.0V	10V	0.5mA	within -3dB @ 1.5V	>30dB	4.5 x 2.2	N/A
* MEC-418PD-02-744**	Pad	-74	100 ~ 10,000	2.0V	10V	0.5mA	within -3dB @ 1.5V	>30dB	4.5 x 1.8	N/A

*RL 2.2K where noted

**Also available in Back Electret